

Use With Jcw 2 Gravimetric-Type Blender

Can you trace and verify resin use from raw material to molded product? Traceability and verification are possible with Matsuis management system!

Traceability System



Overview Resin tracking is critical for accurate material management. Material usage management is possible through data registration, customer orders, recipes and so on. Measurement totals for every order, and traceability are possible.

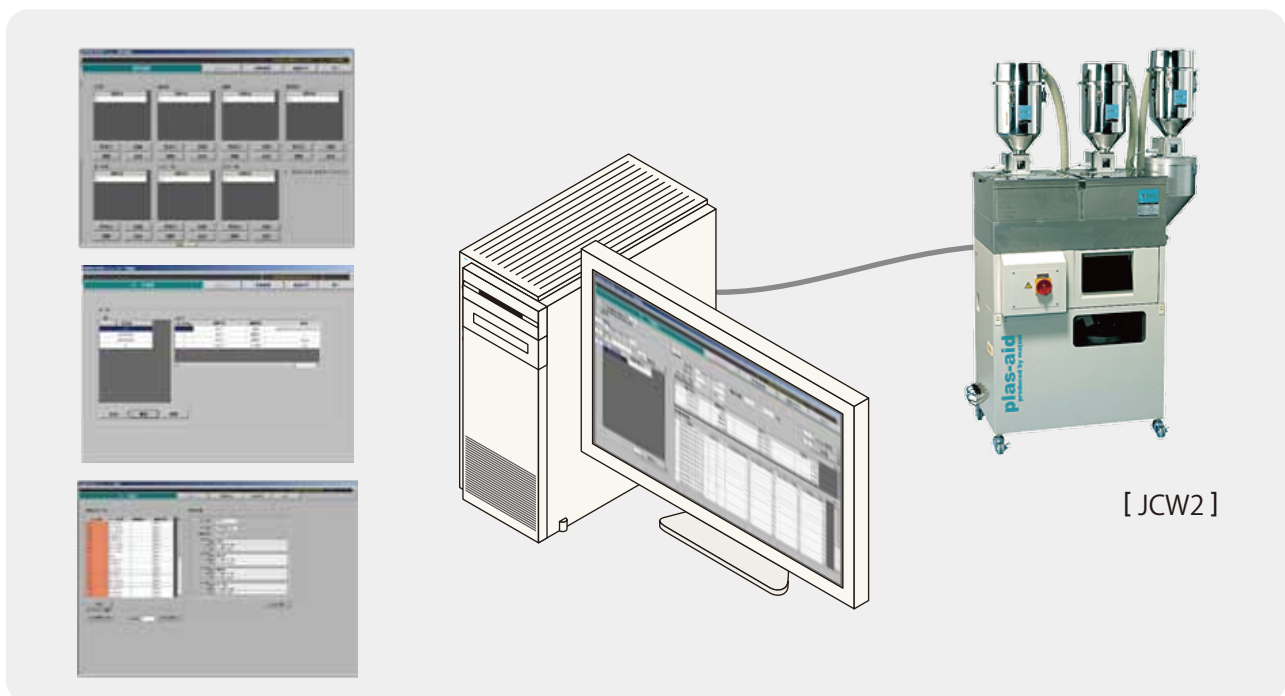

Features

- Reduce human errors.
- Increase efficiency
- Long-range data management
- Enable data sharing.
- Lower labor costs.

